

# NextCloud

All Sterrewacht users have access to our own NextCloud server. You can use your Sterrewacht account to login.

Since OwnCloud is not supported any more, you can “migrate” to the NextCloud server. The easiest way to do it is to create **Online Accounts** on your Linux desktop for both OwnCloud and NextCloud, and then use your file manager to copy-paste (drag-and-drop) all the files from OwnCloud to NextCloud.

The **Online Accounts** is supported for some major desktops, such as Gnome, Cinnamon and KDE Plasma.

## Enable NextCloud in a file manager

### Create Online Account

On your Linux PC open **Online Accounts** interface and create a new account by clicking on the NextCloud button. You can search for Online Accounts in your main search interface or access it via the main system settings interface.

Use <https://nextcloud.strw.leidenuniv.nl/> for the Server field. For the Username and Password fields use your Sterrewacht credentials.

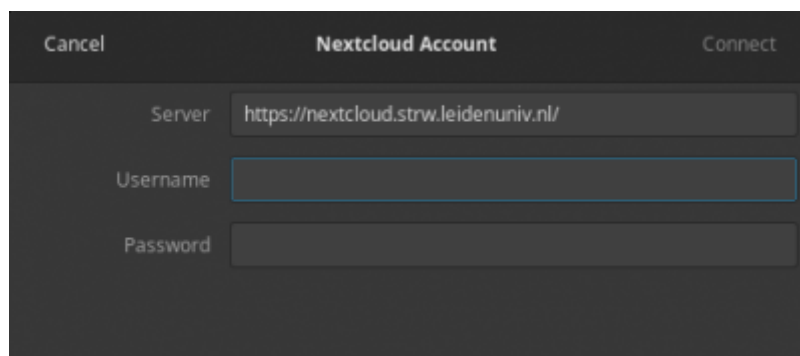
A screenshot of a dark-themed dialog box titled "Nextcloud Account". At the top left is a "Cancel" button, and at the top right is a "Connect" button. The dialog contains three input fields: "Server" with the text "https://nextcloud.strw.leidenuniv.nl/", "Username" (empty), and "Password" (empty). The "Server" field has a small icon to its left, and the "Username" and "Password" fields have small icons to their left.

After this you may encounter notifications about not trustworthy certificate authority. If you have an option to *accept the risk and continue* or *ignore*, use those to move further. For those, who don't have such options, it might not be possible to continue. In this case contact helpdesk for another solution.

### Use File Manager

After successfully creating an Online Account for NextCloud, you must be able to use your file manager to access your files. It will be shown on the left pane of the file manager window.

## Enable OwnCloud in a file manager

For OwnCloud you can repeat the steps for NextCloud except that it does not require to bypass the 2FA, so you can skip that step and use your Sterrewacht credentials when creating an Online Account. You will need to use the NextCloud button in the **Online Accounts** and <https://owncloud.strw.leidenuniv.nl/> as a server.

## Keyring password

In case you get a window with a request to enter your keyring password and you can't skip it, provide the password. If you don't know the password you will need to disable it for this session. For this open **Passwords and Keys** application and delete the record with name **Login** (right click). It will be recreated during your next login.

## Optional: Bypass 2FA

NextCloud provides a way to bypass two-factor authentication. Open NextCloud in your browser by clicking <https://nextcloud.strw.leidenuniv.nl/> , login and in the top right corner click on the menu button with your initials.

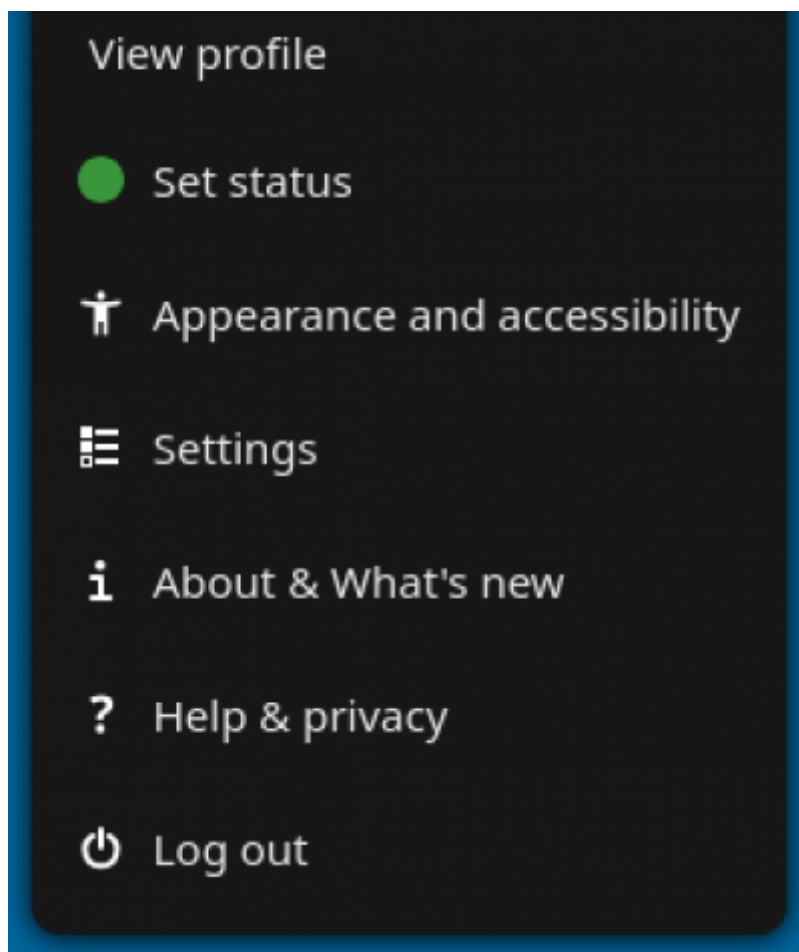

Click on the **Settings** and on the new page click on **Security** tab. You should see a page like the following:

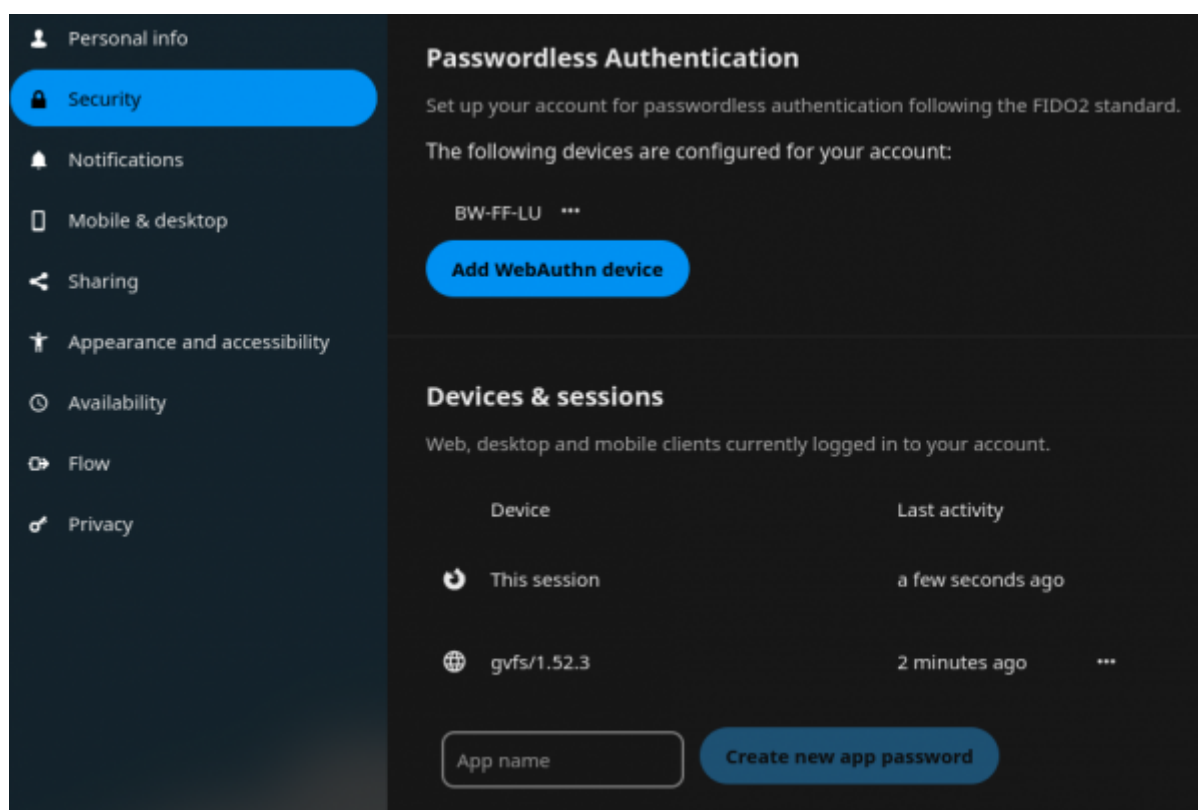

On this page click on the **Add WebAuthn Device**. You may be asked for a password and the device name. Then it will display a window with your user name and a pass phrase. You may want to store those somewhere, although they are not used anywhere explicitly. If you use a password manager in your browser, it may ask you to generate a Passkey.

Now you must be ready for the next step.

From:  
<https://helpdesk.strw.leidenuniv.nl/wiki/> - Computer Documentation Wiki

Permanent link:  
<https://helpdesk.strw.leidenuniv.nl/wiki/doku.php?id=linux:nextcloud&rev=1729610150>

Last update: **2024/10/22 15:15**

